

Riser Rail Installation Guide

Part No. 24029 DEC 2025

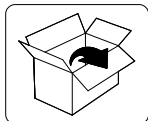

Parts included

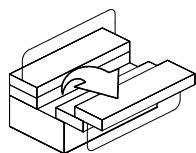

Required tools

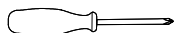

Ø6mm

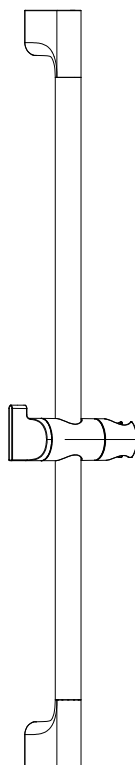
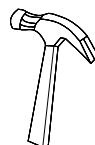

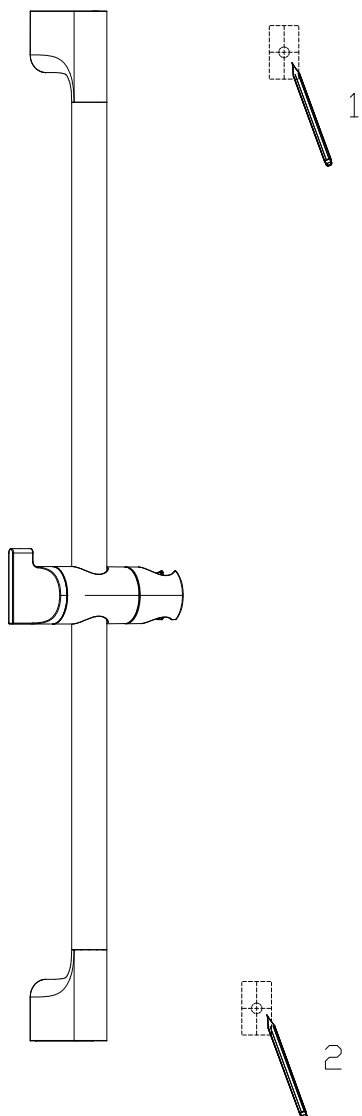

Use pencil to mark out pilot holes.

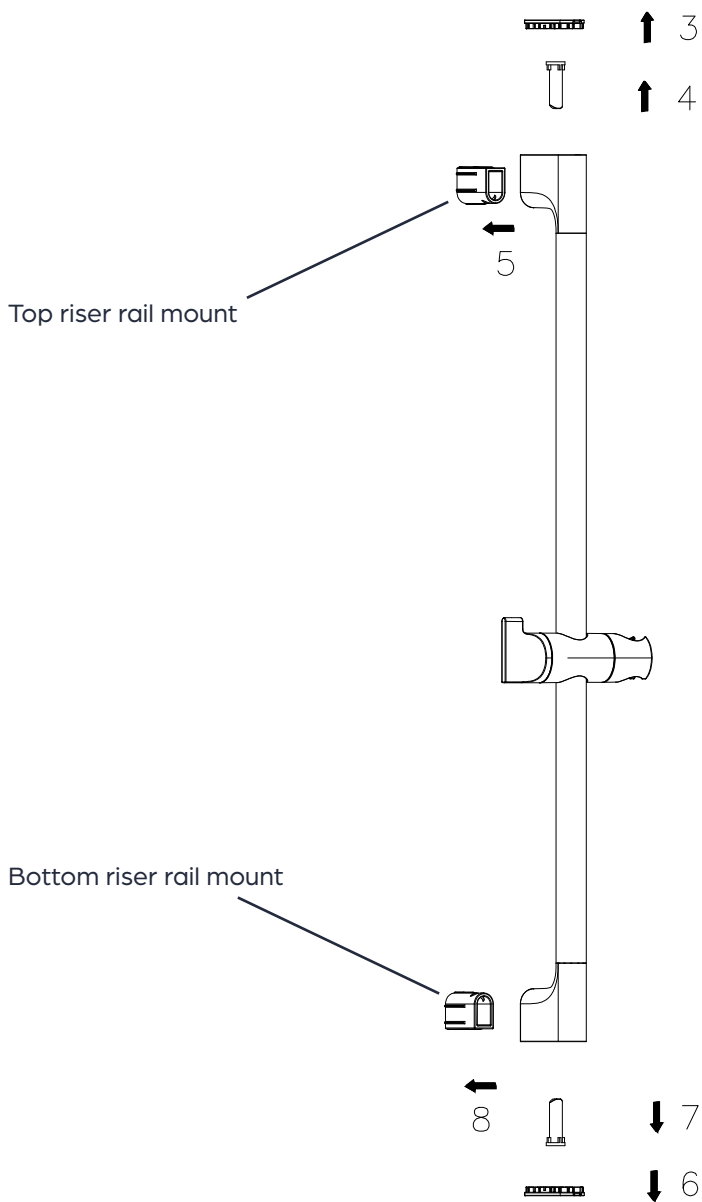

Disassemble riser rail in the order shown.

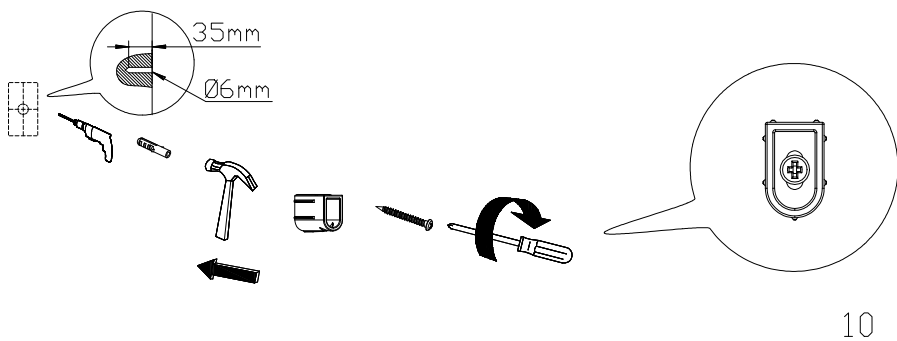
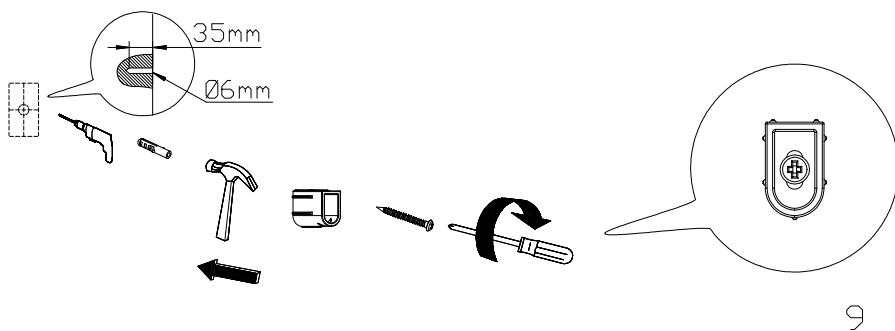

Use screws provided to secure top and bottom riser rail mounts to wall.

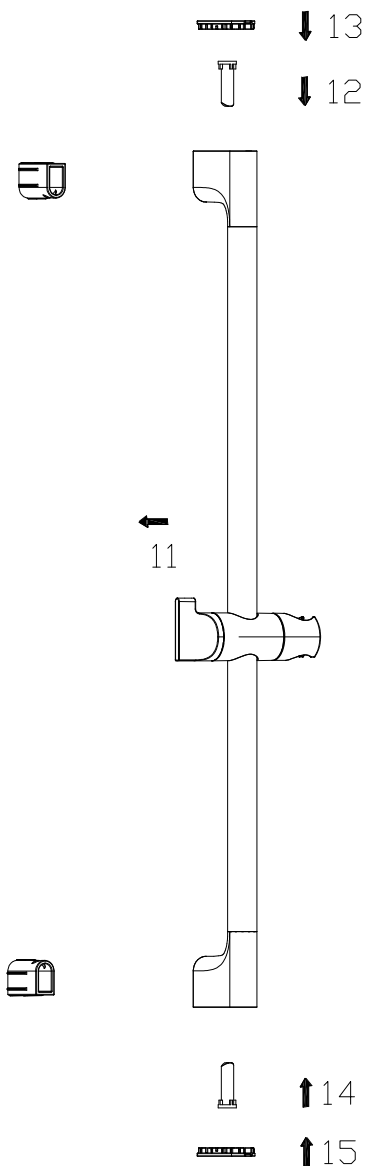

Mount riser rail to the riser rail mounts. Secure riser rail to mounts using the bolts provided.